

Slant Anchor

Unique anchor provides simple panel-to-foundation connection without welding or bolting

The Slant Anchor is an assembly used to connect tilt-up or precast panels to a foundation. The assembly includes a load-rated Slant Anchor, foam Void Former, high-strength Ductile Bar and prepackaged Flowable Grout.

The Slant Anchor is an integral part of the panel design and planning. The anchor is positioned and reinforced in each panel during concrete forming operations. The foam Void Former covers the connection sleeve.

When a completed concrete panel is ready for installation, the foam Void Former is located and removed. The connection sleeve is now visible and accessible for anchoring.

Each concrete panel is positioned on the foundation and braced. A 1" hole is drilled, using the connection sleeve as a guide, into the foundation to the required depth.

The hole is then partially grouted, the Ductile Bar is fully inserted, and the remaining grout is used to fill the sleeve. This grouted connection anchors the panel without welding or bolting.

The safe working load of the Slant Anchor is 9,000 lbs for uplift, horizontal and shear forces, at a 3:1 safety factor. This meets the tensile strength requirements of ACI-318 16.5.1.3(b).

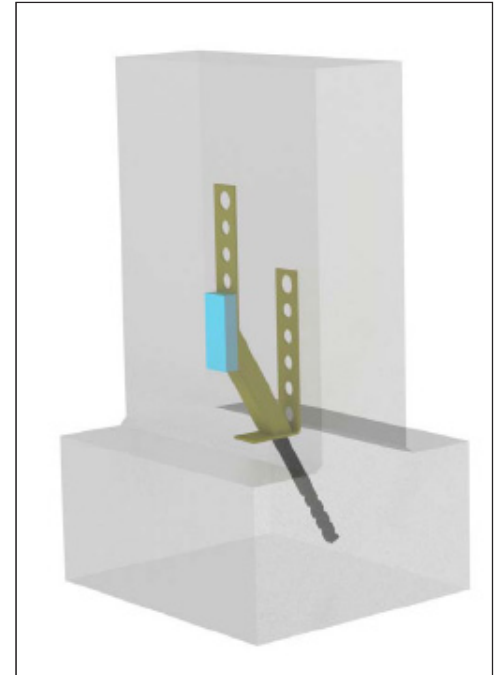

The Slant Anchor assembly is a load-rated panel connection, without welding or bolting.



The Slant Anchor is simply positioned and nailed to the form.



After the installation is complete, there is only a very small opening to patch.

Slant Anchor Description				
Model	Panel Width	Part Number	Grout	Finish
Precast	5-1/2" to 7"	SBPSAC	Cement	Painted
		SBPSACG		Galvanized
Tilt-Up	7" minimum	SBTSAC	Cement	Painted
		SBTSACG		Galvanized

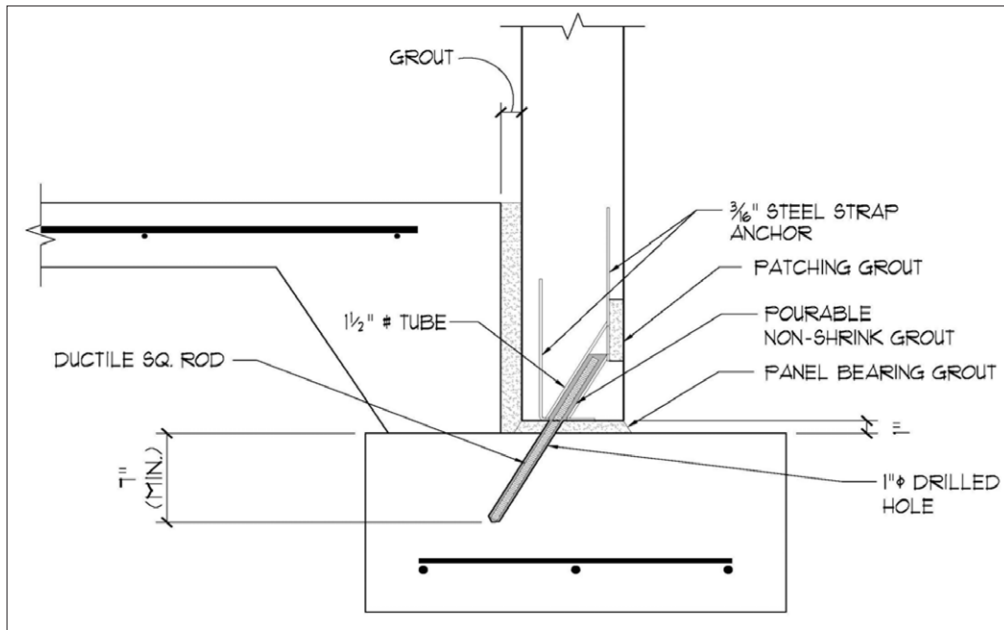

Slant Anchor Installation Guidelines

1. Position and reinforce the Slant Anchor before casting panel.
2. Erect panel, brace and install bearing grout as required.
3. Locate and remove foam Void Former from connection face.
4. Drill 1" dia. hole into the foundation using the sleeve as a guide.
5. Remove dust from hole using compressed air, vacuum and/or bottle brush.
6. Mix Flowable Grout and pour into the connection cavity until half full.
7. Place Ductile Bar into sleeve and foundation immediately after grouting.
8. Add additional grout to cover the bar and fill the cavity.
9. Allow grout to cure before patching/finishing the panel face.

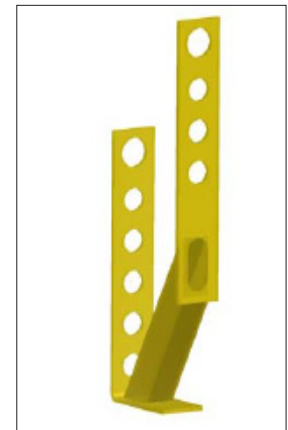

*Slant Anchor
Tilt-Up Version*

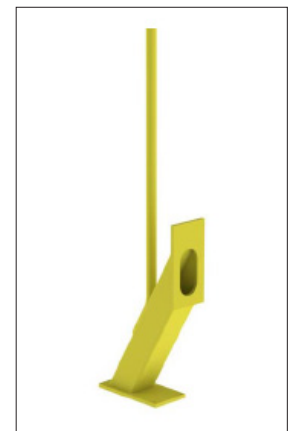

*Slant Anchor
Precast Version*



*Ductile Bar
Cut-to-Length*