

Taper Ties

High-capacity, reusable, gangform tie that spreads the tie spacing and reduces the number of ties

Taper Ties are used in forming situations where the ties are completely removed from the concrete after the pour has cured. Commonly used with gangform systems, Taper Ties enable contractors to efficiently assemble and strip formwork. Applying waterproof grease evenly on each Taper Tie prior to concrete placement facilitates removal.

Taper Ties are squared-off at each end, allowing the tie to be turned with a wrench during the removal process. The tie can also be struck on the squared-off end of the smaller side with a hammer for removal from the gangform and wall.

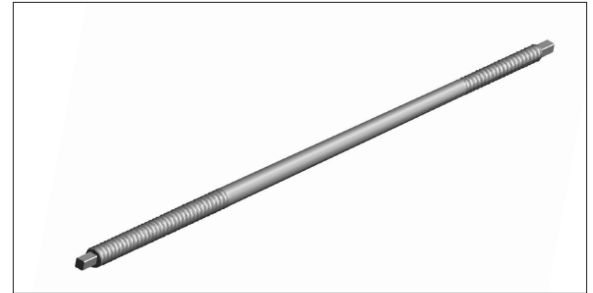

High-capacity Taper Ties reduce the number of ties needed for gangforming.



An assembly consists of the Taper Tie, two Flat Washers, and two Wing Nuts.



Hitting Taper Ties on the squared end will avoid thread damage and stripping difficulty.

Taper Ties*		
Part No.	Description	SWL** (lbs)
SBTT303412	SB Taper Tie 30" 1/2:3/4	7,500
SBTT363412	SB Taper Tie 36" 1/2:3/4	7,500
SBTT423412	SB Taper Tie 42" 1/2:3/4	7,500
SBTT36341	SB Taper Tie 36" 3/4:1	18,000
SBTT42341	SB Taper Tie 42" 3/4:1	18,000
SBTT48341	SB Taper Tie 48" 3/4:1	18,000
SBTT60341	SB Taper Tie 60" 3/4:1	18,000
SBTT361114	SB Taper Tie 36" 1:1-1/4	34,000
SBTT421114	SB Taper Tie 42" 1:1-1/4	34,000
SBTT481114	SB Taper Tie 48" 1:1-1/4	34,000
SBTT601114	SB Taper Tie 60" 1:1-1/4	34,000
SBTT36114112	SB Taper Tie 36" 1-1/4:1-1/2	50,000
SBTT42114112	SB Taper Tie 42" 1-1/4:1-1/2	50,000
SBTT48114112	SB Taper Tie 48" 1-1/4:1-1/2	50,000
SBTT60114112	SB Taper Tie 60" 1-1/4:1-1/2	50,000

* Other sizes available on request.

** Safe Working Load (tension) at safety factor of 2:1.

Wing Nuts		
Part No.	Description	SWL* (lbs)
SBWN12	SB Wing Nut 1/2"	9,000
SBWN34	SB Wing Nut 3/4"	18,000
SBWN1	SB Wing Nut 1"	38,000
SBWN114	SB Wing Nut 1-1/4"	52,000
SBWN112	SB Wing Nut 1-1/2"	80,000



* Safe Working Load (tension) at safety factor of 2:1, but may be limited by Taper Tie capacity.

Flat Washers*		
Part No.	Description	Dimensions
SBFW12551316	SB Flat Washer 1/2" Plate	5" x 5" with 13/16" Hole
SBFW12551116	SB Flat Washer 1/2" Plate	5" x 5" with 1-1/16" Hole
SBFW34551316	SB Flat Washer 3/4" Plate	5" x 5" with 13/16" Hole
SBFW34551116	SB Flat Washer 3/4" Plate	5" x 5" with 1-1/16" Hole
SBFW34551516	SB Flat Washer 3/4" Plate	5" x 5" with 1-5/16" Hole
SBFW1551116	SB Flat Washer 1" Plate	5" x 5" with 1-1/16" Hole

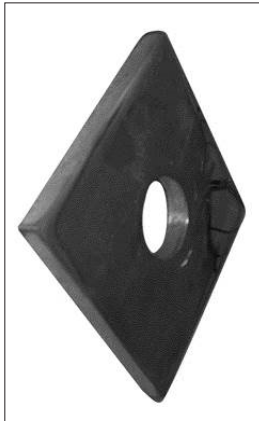

* Other sizes available on request.

Installation:

1. Slide the proper size flat washer and thread a wing nut on to the coil thread of the larger side on each taper tie.
2. Apply waterproof grease that is not affected by the chemicals in concrete onto the tapered surface of each tie.
3. Align forms and insert a taper tie through the waler on the back, then guide it through the face, rebar and opposite gang.
4. Slide a flat washer on the open side of the taper tie and thread a wing nut, adjusting it as needed until the forms are set in position.
5. Once the concrete has been placed and cured, remove the wing nut and flat washer from the smaller end of the taper tie.
6. Use a hammer to strike the taper tie on the smaller end to remove it from the gangforms and wall.

Taper Tie Thread Dimensions			
Large End		Small End	
Thread Diameter	Thread Length	Thread Diameter	Thread Length
3/4"	10"	3/4"	6"
1"	10"	1"	6"
1-1/4"	10"	1-1/4"	6"
1-1/2"	10"	1-1/2"	6"