

# Walers

## Double channel steel walers turn everyday panels into productive gangform systems

Contractors own lots of different forming equipment, but they don't always own enough walers... the one thing that can really maximize forming productivity!

Walers are used to align panels, carry taper tie loads and maximize the surface area of each gang. Depending on the type of panel and contractor preference, there are several waler alternatives.

### Butt Plate Waler

The Butt Plate Waler is one of the most popular waler designs. Double 6" steel channel has 13/16" holes for 3/4" bolts, spaced on 6" centers, for waler attachment hardware. The channels are positioned back-to-back and separated by a 3" gusset or spacer sleeve. The 1/2"x9"x9" steel plates have holes for end-to-end connections so different waler lengths can be combined. (See following page for sizes)

### Pafco-Style Waler

The Pafco-Style Waler looks just like the Butt Plate Waler, except for the additional 9/16" holes, spaced on 12" centers, along the bottom flanges. These flange holes provide for other types of waler attachment hardware. (See following page for sizes)

### Double Channel Waler

The Double Channel Waler is another common waler design. Double 5" steel channels have 13/16" holes for 3/4" bolts, spaced on 6" centers, for waler attachment hardware. The steel channels are positioned back-to-back and separated by a 3" gusset or spacer. (See following page for sizes)



*Butt Plate Walers, bolted together end-to-end, are used to support this large wood beam gang.*



*Butt Plate Walers have 1/2"x9"x9" end plates with slotted holes for end-to-end connections.*



Walers*	
Part No.	Description
SBBPW2	Butt Plate Waler 6"x2'
SBBPW4	Butt Plate Waler 6"x4'
SBBPW6	Butt Plate Waler 6"x6'
SBBPW8	Butt Plate Waler 6"x8'
SBBPW10	Butt Plate Waler 6"x10'
SBBPW12	Butt Plate Waler 6"x12'
SBPSW2	Pafco-Style Waler 6"x2'
SBPSW4	Pafco-Style Waler 6"x4'
SBPSW6	Pafco-Style Waler 6"x6'
SBPSW8	Pafco-Style Waler 6"x8'
SBPSW10	Pafco-Style Waler 6"x10'
SBPSW12	Pafco-Style Waler 6"x12'
SBDCW4	Double Channel Waler 5"x4'
SBDCW6	Double Channel Waler 5"x6'
SBDCW8	Double Channel Waler 5"x8'
SBDCW10	Double Channel Waler 5"x10'
SBDCW12	Double Channel Waler 5"x12'

\* Custom sizes available on request.

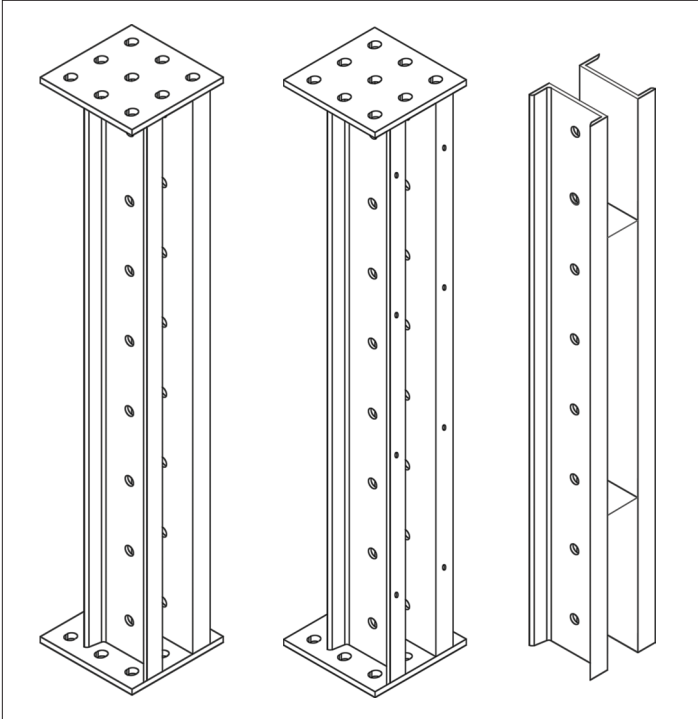

Walers (left to right) - Butt Plate Waler, Pafco-style Waler and Double Channel Waler.

