

Panel Base Connector - P*

Eliminate misaligned embed plates and field welding by bolting panels directly to the foundation

The Panel Base Connector-P is easy to position and fasten at the bottom edge of the form. It can be placed in either a face-up or face-down orientation depending on the forming and handling preference.

The high-strength, purpose designed drill-in 3/4"x10" screw anchor provides an immediate and secure connection when tightened. There is no grout set-up or wait time.

The connection is centered in the concrete panel, minimizing moment and eccentric forces in the design, and resisting in-plane tension and out-of-plane shear forces.

The connection provides a nominal capacity in excess of 10 Kips for shear and tension, meeting the applicable ACI requirements.

The relatively small access area is easy to grout, providing complete embedment and encapsulation for corrosion protection.

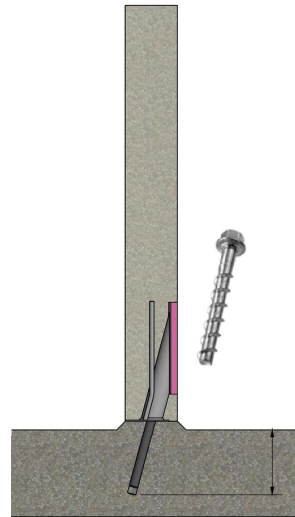

Note: 7" Screw Anchor engagement required

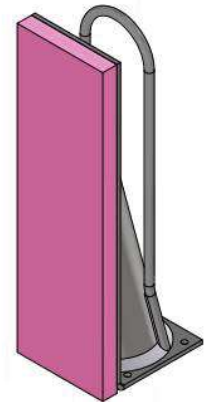

Meets ACI integrity requirements of ACI-318 -11 16.5.1.3(b) ACI318-14 16.2.4.3(b), ACI-318-19 16.2.4.3 (b), and ACI 551.2R-15 Chapter 8.

Panel Base Connector Kit	
Part No.	Description
SBPBCP34HD10KIT	10" Panel Base Connector - P Kit w/ 3/4" x 10" Screw Anchor

* 12" available if spacing between bottom of panel and footing is more than 2".

Panel Base Connector Capacity			
Test Type	Wall Thickness (in)	Ultimate Load (lbs)	Displacement (in)
Shear 90 degree	7-1/4	37544	1/2
Face-to-face between panel	8		
Shear perpendicular inline between panels	7-1/4	28880	1/2

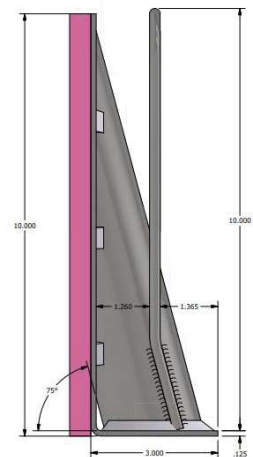

10" PBC-P

* Patent No.: U.S. 11,891,790

SureBuilt
Concrete Forms & Accessories

2525 Armitage Ave
Melrose Park, IL 60160
708-493-9569
www.surebuilt-usa.com



Basic Installation

1. Position and fasten the Panel Base Connector to the desired location(s) in the bottom edge of panel formwork using the holes provided.
2. Cast, lift, handle and erect the completed panel on the concrete footing or foundation as typical.
3. Remove the foam cover from the face of Panel Base Connector.
4. Drill a minimum 3/4" x 7" hole, using a 3/4" x 24" bit through the opening of the Panel Base Connector into the footing or foundation.
5. Clean/vacuum the concrete dust from each hole.
6. Place the 3/4" x 10" screw anchor through the Panel Base Connector into the footing or foundation.
7. Torque anchor into the footing or foundation with a maximum of 150 ft.-lbs. Do not over-torque anchor.
8. Fill the access cavity with grout and finish flush with panel surface.

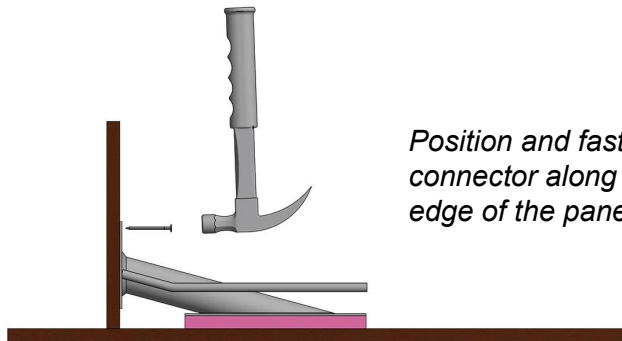
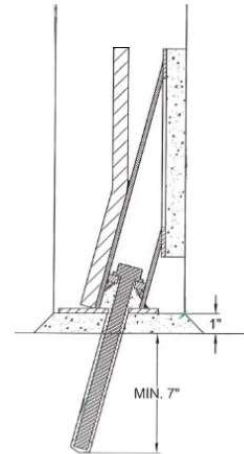

Position and fasten the connector along the bottom edge of the panel formwork.

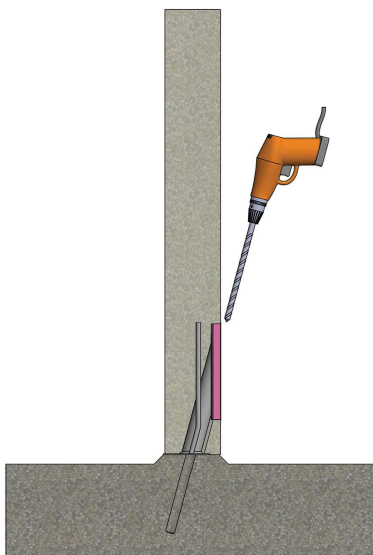

Drill a 3/4" x 7" hole, using a 3/4" x 24" bit, through the opening of the connector into the footing or foundation.

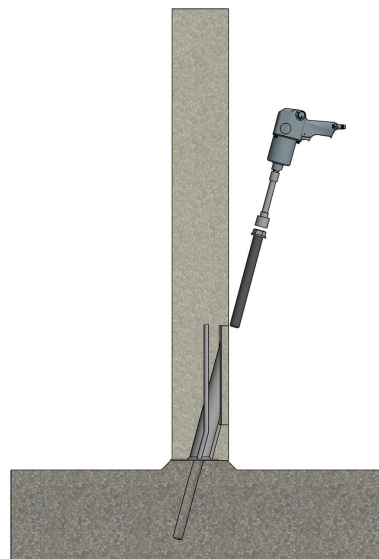

Place a 3/4" x 10" screw anchor through the connector and footing or foundation, then torque to 150 ft.-lbs.

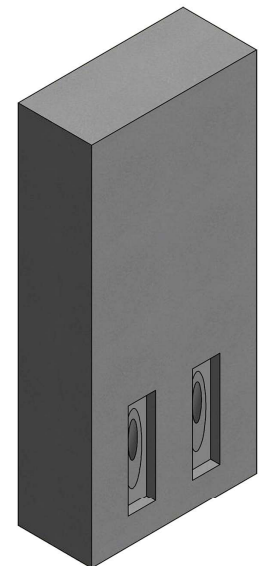

Fill the cavity with grout and finish flush with surface.