

FRP Wire Mesh

High tensile strength W1.4 and W2.9 fiber wire mesh

Fiber Reinforced Polymer combines high strength fibers with chemically resistant, load transferring polymers.

Applications

- Precast product reinforcement
- Shotcrete reinforcement
- Concrete structure rehabilitation
- Flatworks and slab-on-grade shrinkage control

FRP Wire Mesh is resistant to corrosion from chlorides, retains its flat shape when unrolled, is 1/3 the weight of steel, and twice as strong as steel.



FRP Wire Mesh Mechanical Properties

Wire Size	Nominal Diameter		Nominal Area		Ultimate Tensile Force		Mean Ultimate Strength		Tensile	
	in	mm	sq. in	sq. mm	lb	kN	ksi	MPa	ksi	MPa
10 Gauge	0.134	3.4	0.014	9.03	2,040.05	9.07	145	1000	6887.5	47500
6 Gauge	0.192	4.88	0.029	18.7	4,202.65	18.69	145	1000	6887.5	47500

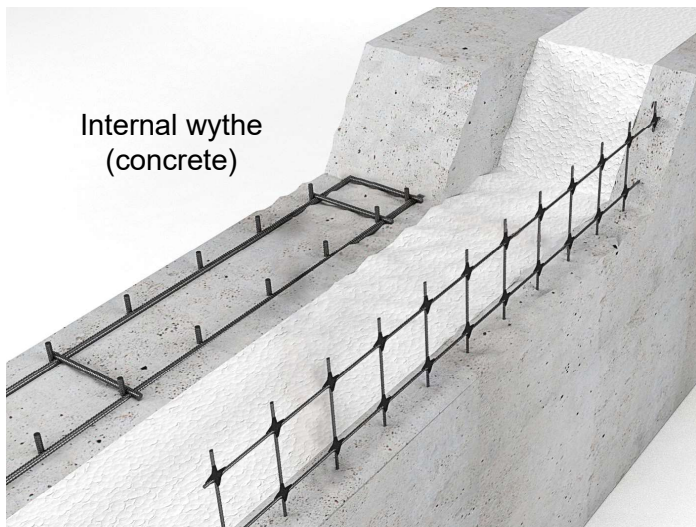

Thermal insulation layer External wythe (concrete)

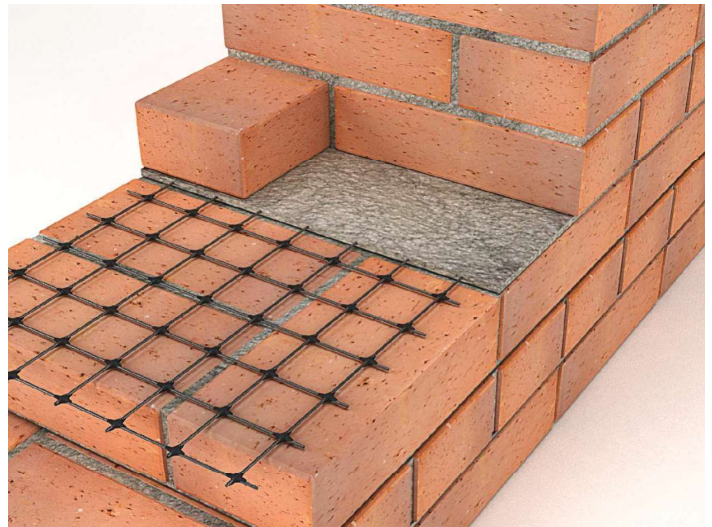

Composite mesh is designed to replace conventional metal mesh used for reinforcement of various construction structures.

SureBuilt
Concrete Forms & Accessories

840 South 25th Ave
Bellwood, IL 60104
708-493-9569
www.surebuilt-usa.com

FRP Wire Mesh is in Compliance with ASTM 7957 and ACI 440-22.

FRP Wire Mesh Cross Sectional Area						
Wire Size	Nominal Diameter		Nominal Area		Fiberglass Wire Mesh Cross Sectional Area	Area per Unit of Width for Center-to-Center Wire Spacing
	in	mm	sq. in	sq. mm	6 sq. in / ft	150 sq. mm / m
10 Gauge	0.134	3.4	0.014	9.03	0.028	60.5
6 Gauge	0.192	4.88	0.029	18.7	0.058	124.63

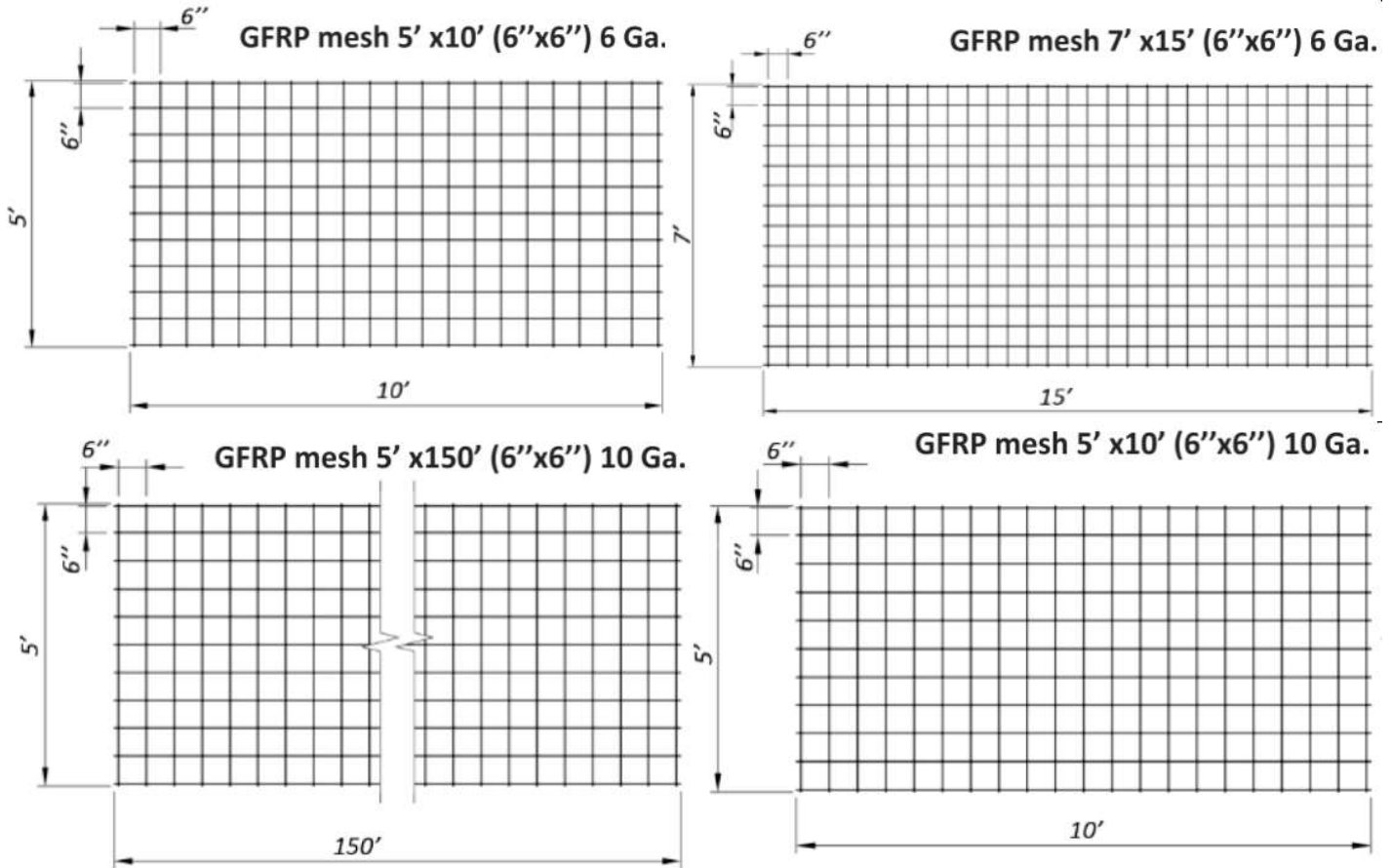

GFRP Wire Mesh Standard Rolls								
Wire size	Width		Length		Spacing		Roll Weight	
	ft	mm	ft	mm	in	mm	lbs	kg
GFRP W1.4 (10 Ga.)	5	1524	150	45720	6x6	150x150	40.25	18.26

GFRP Wire Mesh Standard Sheets											
Wire size	Width		Length		Spacing		Sheet Weight		Package	Skid Weight	
	ft	mm	ft	mm	in	mm	lbs	kg		pcs	lbs
GFRP W1.4 (10 Ga.)	5	1524	10	3048	6x6	150x150	2.68	1.22	100	268.3	121.7
GFRP W2.9 (6 Ga.)	5	1524	10	3048	6x6	150x150	5.98	2.71	100	597.9	271.2
	7	2133	15	4572	6x6	150x150	12.55	5.69	50	627.6	284.7