

SureBuilt

Concrete Forms & Accessories

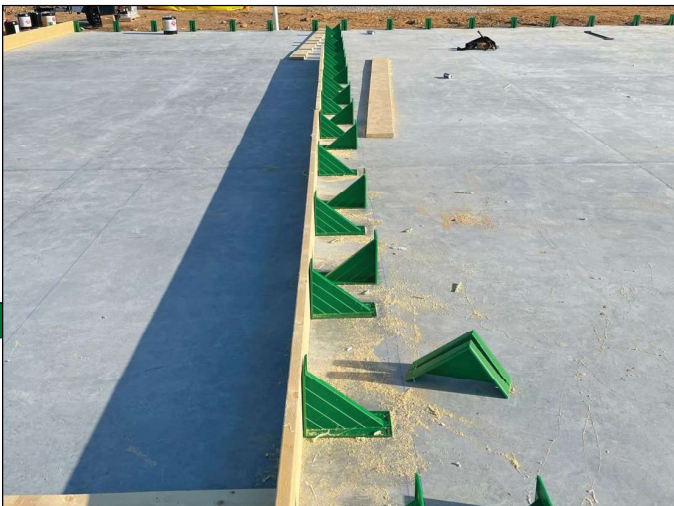

Edge Form Brackets



Edge Form Bracket 6x8, 9x11

Reuse instead of cutting lumber blocks for bracing and start forming faster

The one-piece plastic design is a wedge-shape that braces tilt-up edge forms. The 6x8 Edge Form Bracket has a 6" side for slabs 6" to 7", and an 8" side for slabs 8" to 9". The 9x11 Edge Form Bracket has a 9" side for slabs 9" to 11", and a 11" side for slabs 11" to 13".

Both sides of the Edge Form Bracket have a flat surface with holes for attachment .

The top of the Edge Form Brackets should always be positioned below the overall form height so they do not interfere with concrete screeding or finishing.

| Edge Form Bracket 9x11 | |
|------------------------|--------------------------|
| Part No. | Description |
| SBEFX9X11 | Edge Form Bracket 9"x11" |
| SBEFG6X8 | Edge Form Bracket 6"x8" |



The 9x11 Edge Form Bracket can be nailed, screwed or glued to lumber and concrete. The brackets can be stripped, stacked, saved and reused.

Tack It - Edge Form Brackets* have sides with holes for nail attachment to lumber and concrete. 1/4"x1" plastic nails are available.

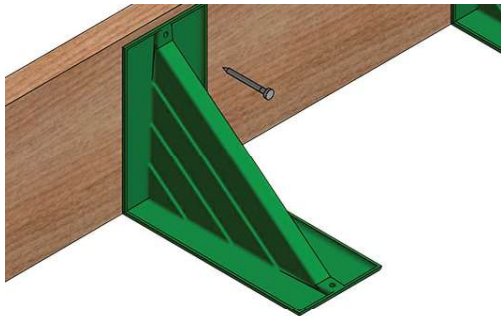

Scrape It - Edge Form Brackets can be removed from surfaces with a long-handle scraper and cleaned.

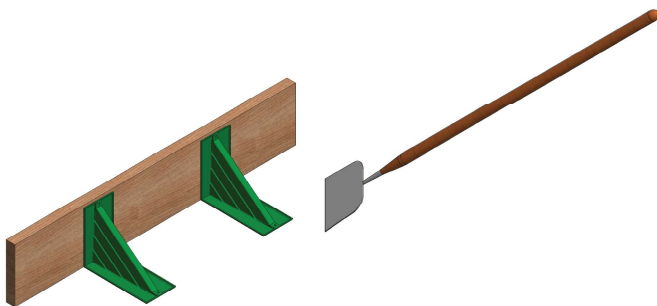

Stick It - Edge Form Brackets have flat sides for Spray Adhesive or All Weather Adhesive attachment.



Stack It - Edge Form Brackets "nest" together for handling and storage.

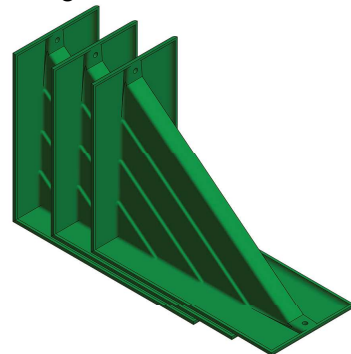

Construction Adhesive

Position, bond, and remove materials in tilt-up casting beds

Construction Adhesive

A high-strength, fast-drying, low VOC, pressure-sensitive adhesive used for positioning chamfers, reveals and rustications in tilt-up casting beds. Suitable for concrete, metal, plastic and wood surfaces.

All Weather Adhesive

A one-part, moisture cure that can be used in both wet and dry conditions to adhere a variety of substrates. The high strength bond is flexible and can provide sealant properties. Its high initial green strength and non-slump formula is ideal for both vertical and horizontal applications. Cure time can be 24 hours or more, depending on the environment.



Construction Adhesive Edge Form Bracket Installation

| Adhesives & Cleaner | | |
|---------------------|--|---------------------------|
| Part No. | Description | Packaging |
| SBFCA14 | Construction Adhesive - LVOC Inverted Aerosol Spray - 14oz can | 12/case, 108 cases/pallet |
| SBFAWA20 | All-Weather Adhesive - 20 oz sausage - 100% solids | 12/case, 45 cases/pallet |
| SBFCA28 | Construction Adhesive - Canister Tank Spray - 28 lbs | 36/pallet |
| SBFAC5 | Adhesive Cleaner - 5 gallon pail | 36/pallet |



Construction Adhesive aerosol can



All Weather Adhesive - sausage



Construction Adhesive aerosol canister

Adhesive Cleaner

Adhesive Cleaner was designed to help clean up adhesive residue. The solvent system attacks residue and can be applied with a sponge and applicator. Adhesive Cleaner is great for removing common aerosol adhesives used in tilt-up construction.

Construction Adhesive Guidelines

1. Allow sufficient concrete curing

Allow a minimum of three curing days (seven days preferred) after placing a concrete slab. Check for residual moisture before applying adhesive to a newly-placed concrete surface.

2. Carefully prepare the surface

Bonding surfaces (concrete, metals, plastics, wood) must be free of oil, dirt, dust and/or other particles. Use a hard bristle brush/broom to clean the surfaces. When necessary, use an angle grinder with a wire cup brush or solvent cleaner.

3. Spray adhesive in a consistent pattern

Applicator tip should be approximately 10 inches from the surface. Constantly move the applicator to minimize overlap and/or over application. Several light spray applications typically provide more consistent and thorough coverage.

4. Provide adequate flash time

Adhesive should be applied to both surfaces, then allowed to “flash off” before matching and bonding those surfaces. Flash time is approximately 1-3 minutes depending on the ambient temperature and weather conditions.

5. Let adhesive dry

Adhesive should be dry to the touch on both surfaces before matching and bonding those surfaces. The adhesive can remain “tacky,” even when it is dry.

6. Apply even pressure to materials

Match treated surfaces and apply heavy, consistent pressure. When bonding longer lengths of materials, be sure they are positioned straight and flat. When bonding longer lengths of materials, be sure to allow approximately 1/16” space for expansion.

7. Check the base

Force from nail guns and/or other power tools can disrupt bonded materials. Allow bonded areas to fully cure before performing other forming operations. Use instant-bond Sticky Sheets to reattach dislodged materials.

8. Water resistance

For reveals and rustications, use impervious materials like plastics. Check adhesive and plastic compatibility before beginning any application. Do not attempt to match and bond wet materials. Incidental moisture after installation is acceptable.