

E2N Square Dowel & Tube

Stabilize construction joints for existing to new concrete floors and flatwork

Designed for joint activation and free horizontal movement of existing-to-new concrete without restraint.

The E2N Square Dowel and Tube has compressible foam on both sides of the 3/4" square steel dowel protected by a plastic tube

This allows new concrete to shrink adjacent to existing concrete without the dowel causing unintended damage to the concrete.

The comparison to the right shows the load transfer on square bars compared to round bars. The load transfer directly down into the concrete effectively eliminates splitting stresses within the concrete.

Square bars have greater resistance to bending, reducing edge and corner curling without increasing the amount of steel used.

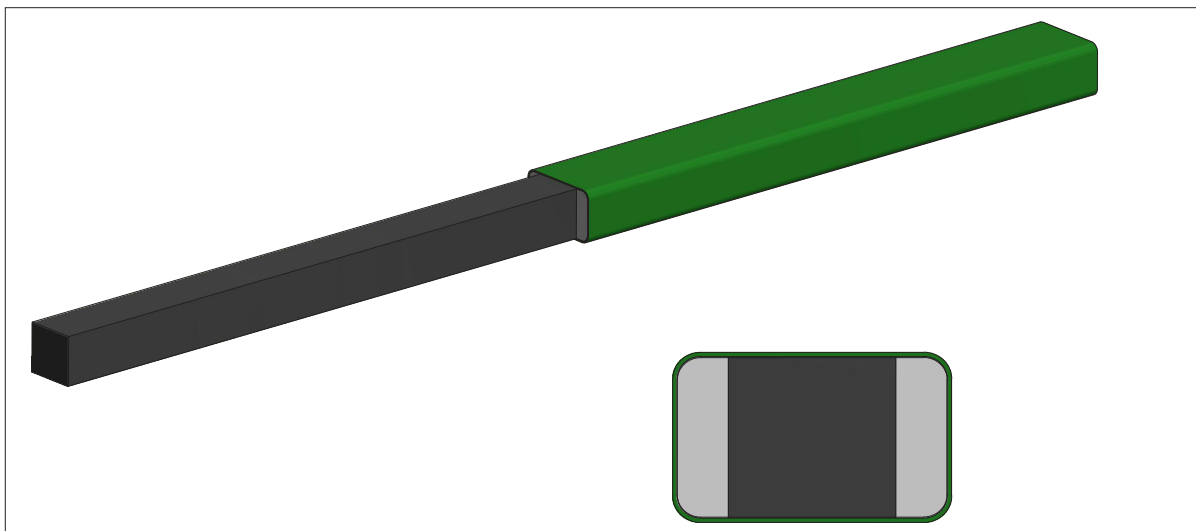
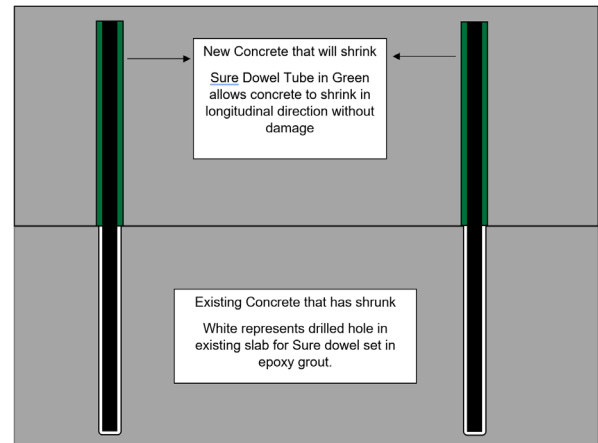
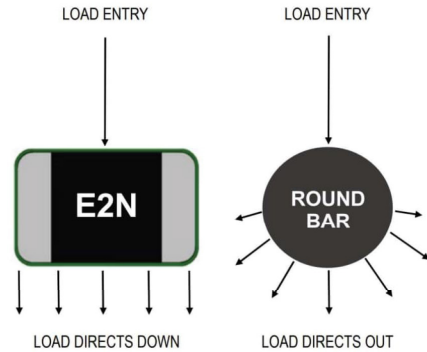

E2N Square Dowel and Tube Installation Guide

1. Drill 1-1/8" hole to 9-1/2" at mid-slab depth. Space E2N Square Dowels at 18" O.C.

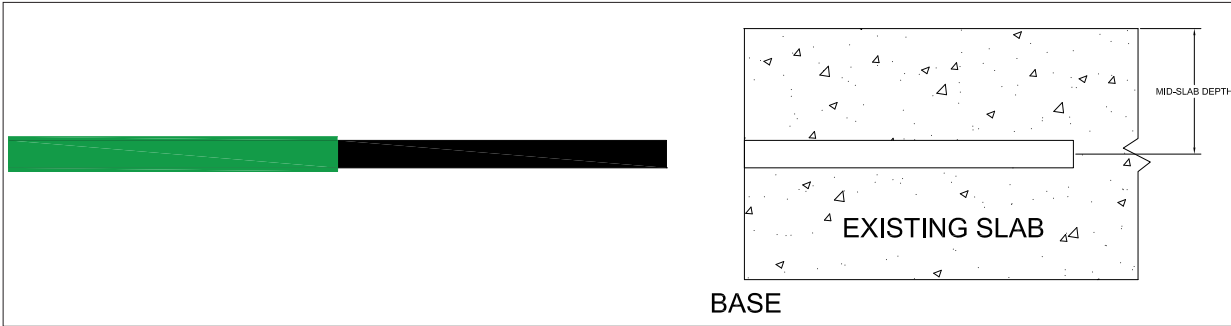

2. Set E2N Square Dowel and Tube in epoxy grout with Tube flush with existing slab and foam on the left and right sides.

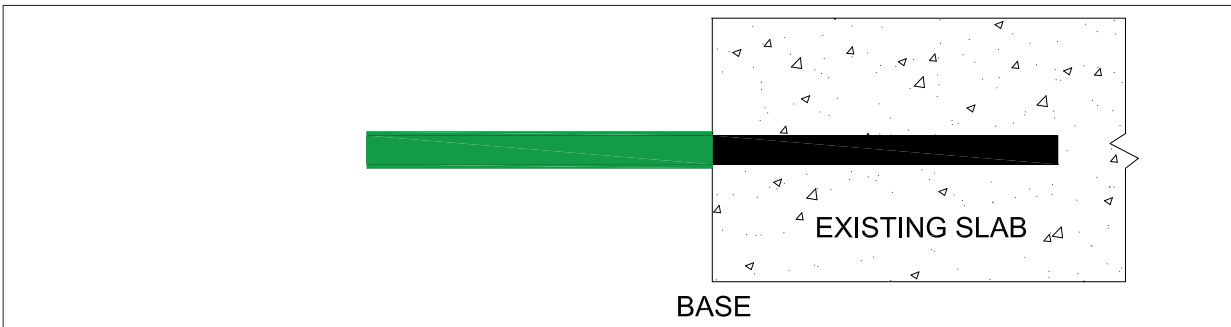

3. Place and finish new concrete.

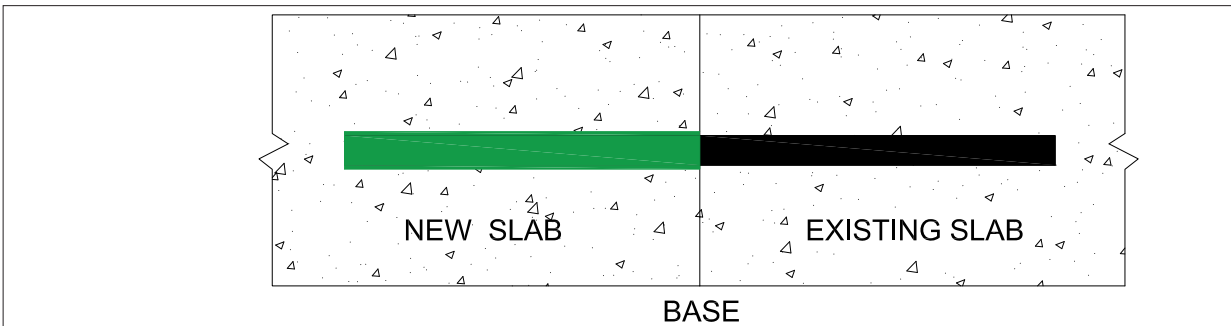

E2N Square Dowel & Tube

Part No.	Description	Slab Thickness	Square Dowel Size	Dowel Length	Square Dowel Clip Length	Embedment (in)
SBSDKTT	Square Dowel & Tube	any	0.75"	18"	9"	9"
SBSDKEAI	Epoxy Acrylic Injection					